

- TOP PERFORMANCE
- TOP QUALITY
- TRIED AND TRUSTED IN THE FIELD

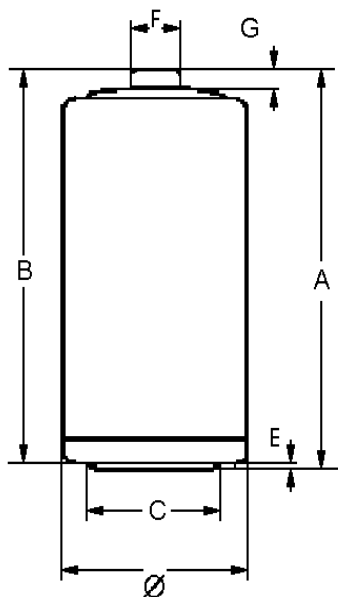

<b>Type Designation</b>	4014
<b>Designation IEC</b>	LR14
<b>System</b>	Zn-MnO <sub>2</sub> (Alkaline)
<b>Shelf Life (Coding)*</b>	5 years
<b>Nominal Voltage [V]</b>	1.5
<b>Typical Capacity C [mAh]</b>	7800 (discharge with high-resistance)
<b>Permissible Temperature Range</b>	- 20 °C ... 50 °C
<b>Weight, approx. [g]</b>	66
<b>Volume [ccm]</b>	26

<b>Dimensions [mm]</b>	<b>min:</b>	<b>max:</b>
∅	24.9	26.2
A	-	50.0
B	48.6	-
C	13.0	-
E	-	0.9
F	-	7.5
G	1.5	-



**Typical Capacities (at 20 °C)**

<b>Discharge Type</b>	<b>Load</b>	<b>End Voltage[V]</b>	<b>0.9</b>
4M/H,8H/D,7D/W	3.9 Ω	Time [h]	22,0
Portable lighting		Capacity [Ah]	6,16
		Energy [Wh]	7,82
<b>Discharge Type</b>	<b>Load</b>	<b>End Voltage[V]</b>	<b>0.8</b>
1H/D,7D/W	3.9 Ω	Time [h]	24,6
Toy		Capacity [Ah]	6,95
		Energy [Wh]	7,75
<b>Discharge Type</b>	<b>Load</b>	<b>End Voltage[V]</b>	<b>0.9</b>
2H/D,7D/W	400 mA	Time [h]	12,3
Portable stereo		Capacity [Ah]	4,94
		Energy [Wh]	5,47
<b>Discharge Type</b>	<b>Load</b>	<b>End Voltage[V]</b>	<b>0.9</b>
4H/D,7D/W	20 Ω	Time [h]	125
Radio		Capacity [Ah]	7,65
		Energy [Wh]	9,52

**No publication or circulation of data to third parties without consent of VARTA Consumer Batteries**

\* In consideration of typical loss of capacity at storage and application.