

# Product leaflet

Product	Designation	Ordering No.
Compressed	SR 200 Airline A, PC visor	H03-1012
Air-fed Mask	SR 200 Airline B, PC visor	H03-1112
	SR 200 Airline A, glass visor	H03-1212
	SR 200 Airline B, glass visor	H03-1312

## Product description

The Sundström SR 200 Airline is a breathing apparatus that is supplied with a continuous flow of air and is designed for connection to a compressed air supply. The unique feature of the SR 200 Airline is the scope it provides for filter back up. The SR 200 Airline is available in two designs, i.e. Type A and Type B:

SR 200 Airline-A. The breathing hose can be released from both the facepiece and the control valve. The equipment can then be used as a filtering device.

SR 200 Airline-B. The breathing hose is fixed to the facepiece and can be released only from the control valve. The SR 200 Airline can be used as an alternative to filtering devices in all situations in which the latter are recommended. This applies especially if the user is doing hard or sustained work, and if the pollutants have poor warning properties or are particularly toxic.

The SR 200 Airline is made of materials that are not liable to give rise to sparking when subjected to friction, which enables the device to be used in an explosive or fire-hazardous environment.

Control valve, flow meter and warning whistle for temporary and continuous monitoring of the air flow are included.

## Technical specification

	SR 200 Airline	EN 139:1994	EN 12419:1999
Working pressure	5 – 7 bar	<10 bar	<10 bar
Air flow rate	150 – 320 l/min	>120 – >300 l/min	>120 – >300 l/min
Temperature range	-10°C – +50°C	-	-
Weight without control valve	750 g	-	-
Low flow warning level	<150 l/min	-	<150 l/min
Nominal protection factor <sup>1</sup>	>62,000	2,000	2,000 (LDM3)
Assigned protection factor <sup>2</sup>	100		

1) Determined by the accredited testing institute INSPEC Testing Services.

2) Specified in BS 4275 and applies to all approved continuous flow airline full-face masks regardless of the test results.

- A. Full-face mask**
- B. Breathing hose with check valve**
- C. Retaining clip**
- D. Belt**
- E. Control valve**
- F. Warning whistle**
- G. Compressed air hose**
- H. Flow meter**
- I. Sealing plug**
- J. Filter**
- K. Filter with sealing cover**

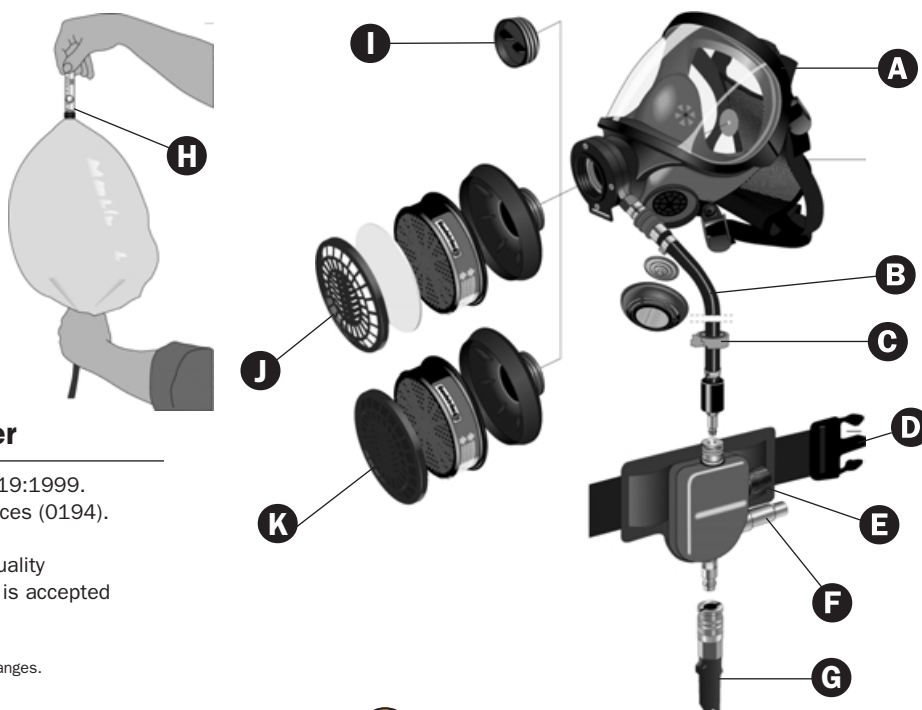

Approved as per EN 139:1994, EN 12419:1999.  
Notified body INSPEC Certification Services (0194).

This product is manufactured within a quality management system (ISO 9001), which is accepted by INSPEC Certification Services.

Product range and specifications are subjected to changes.

**Sundström**

Sundström Safety AB • Tel +46 8 562 370 00 • Fax +46 8 562 370 60  
[www.srsafety.se](http://www.srsafety.se)